

## “S” Type

“S” Type

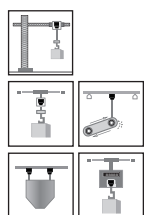
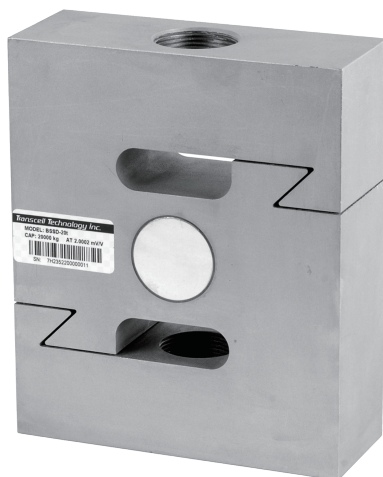
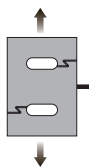

### Capacities

5t, 15t, 20t

### Features

- S-Type load cell
- Nickel-plated alloy steel construction
- Easy to install, stable & reliable
- Suitable for tension measurement, batching systems, and architecture machine, etc.

### Schematic

Red : + input  
Black : - input  
White : - output  
Green : + output

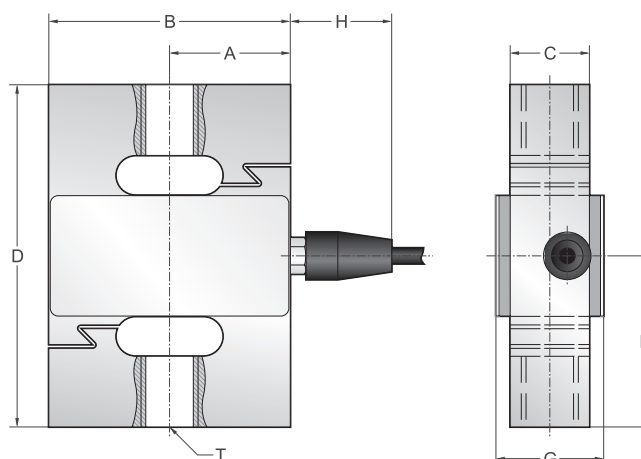
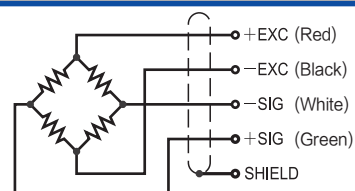

Capacities		A	B	C	D	E	T	G	H
5t	mm	31.8	76.2	25	108	54	M18X1.5	34	32
15t~20t	mm	80	160	60	190	95	M39×2	60	32

### Specifications

Rated Output	2.0mV/V $\pm 0.1\%$	Safe Temp. Range	-10°C to + 70°C
Zero Balance	$\pm 1\%$ of rated output	Temp. Compensated	-10°C to + 40°C
Creep after 30 minutes	$\pm 0.03\%$ of rated output	Safe Overload	150%
Nonlinearity	$\pm 0.03\%$ of rated output	Input Impedance	387 ohm $\pm 20$ ohm
Hysteresis	$\pm 0.03\%$ of rated output	Output Impedance	350 ohm $\pm 5$ ohm
Repeatability	$\pm 0.03\%$ of rated output	Insulation Resistance	$\geq 5000$ M ohm (50V DC)
Temp. effect on output	$\leq 0.002\%$ of applied output/°C	Rated Excitation	10V DC/AC
Temp. effect on zero	$\leq 0.002\%$ of rated output/°C	Maximum Excitation	15V DC/AC
Wire Length	6m	Wire Material	Red(+ E) Black(- E) White(- S) Green(+ S)