

Single Ended Shear Beam

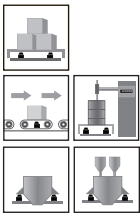

Capacities

250kg, 500kg, 1000kg, 2000kg, 3000kg, 5000kg, 10000kg, 13500kg, 20000kg

Features

- Single ended shear beam load cell
- Stainless steel construction
- Welded Gage Cavity
- High accuracy
- High stability
- Easy to install
- Suitable for floor scales, blending & mixing systems, belt scales and batching Systems, etc.

Schematic

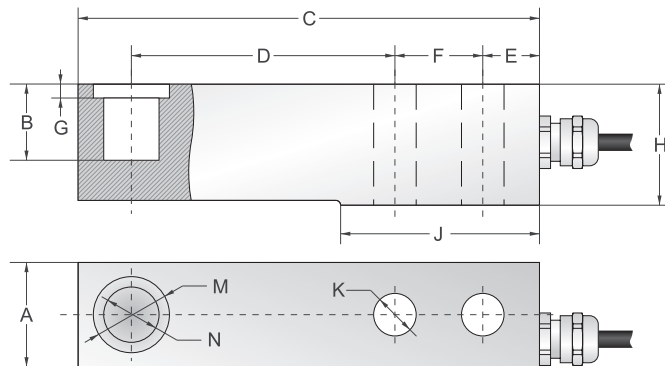
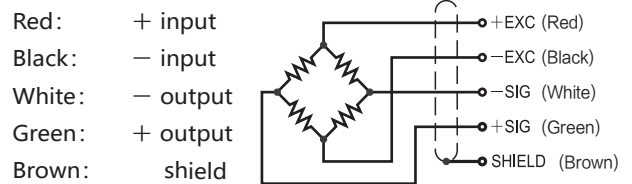

Capacities		A	B	C	D	E	F	G	H	J	K	M	N
0.25t~1t	mm	30.7	17	133.4	76.2	16.4	25.4	4.8	30	57.9	12.7	22	15.9
2t	mm	36.8	23	136.7	76.2	16.7	25.4	9.5	36.6	57.9	12.7	22	15.9
3t	mm	39	23	139.7	79.2	16.7	25.4	9.5	36.6	57.9	15	22	15.9
5t	mm	42.9	29.4	171.5	95.2	16.7	38.1	11	43	73.8	19	34.9	22.2
10t~13.5t	mm	60.4	20.6	279.4	139.7	25.4	82.6	8.6	66.7	133.4	27	47.6	31.8
20t	mm	70	24.2	317.5	158.8	31.8	88.9	9.5	82.6	152.4	33.3	54	38.1

Specifications

Rated Output	2.0mV/V ±0.1%	Safe Temp. Range	-10°C to + 70°C
Zero Balance	±1% of rated output	Temp. Compensated	-10°C to + 40°C
Creep after 30 minutes	±0.03% of rated output	Safe Overload	150%
Nonlinearity	±0.03% of rated output	Input Impedance	387 ohm ± 20 ohm
Hysteresis	±0.03% of rated output	Output Impedance	350 ohm ± 5 ohm
Repeatability	±0.03% of rated output	Insulation Resistance	≥5000 M ohm (50V DC)
Temp. effect on output	≤0.002% of applied output/°C	Rated Excitation	10V DC/AC
Temp. effect on zero	≤0.002% of rated output/°C	Maximum Excitation	15V DC/AC
Wire Length	6m(0.25t~5t) / 9.5m(10t~13.5t) / 13m(20t)	Wire Material	Red(+ E) Black(- E) White(- S) Green(+ S)